

12.5010.00 DA24-Descaling Pump 24V

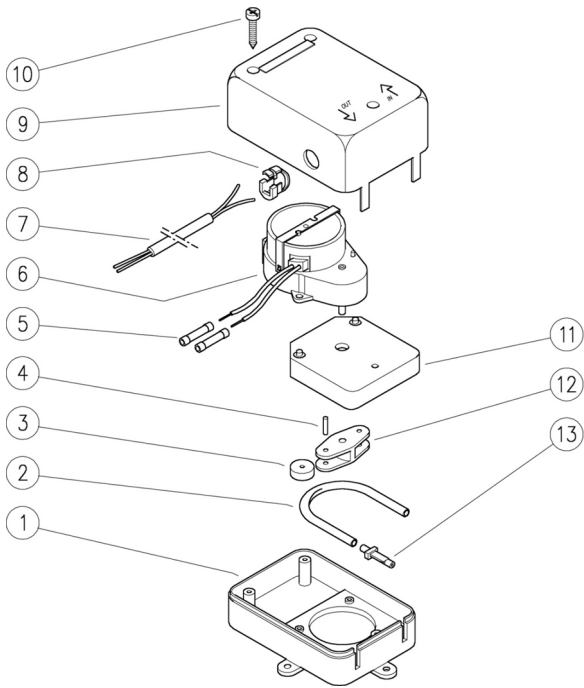

12.5011.00 DA240-Descaling pump 230V

Pos.	P/N	Description	Q.ty
1	21.2003.84	Lower Protection	1
2	21.2006.85	Hose	1
3	21.2008.84	Wheel	2
4	15.1015.12	Parallel pin, 2,5x12 mm Sst.	2
5	12.5017.00	Terminal	2
6	13.0821.24	Gearmotor, 24V AC (1)	1
6	13.0822.00	Gearmotor, 230V AC (2)	1
7	21.2007.21	Cable, 2x0,75 L.1100 mm	1
8	21.2001.84	Cable gland	1
9	21.2004.84	Upper protection	1
10	16.3077.00	S/tapping screw, DIN7981 3,5x18 mm	3
11	21.2002.84	Motor bracket	1
12	21.2009.84	Wheel bracket	1
13	21.2005.84	Hose barb	2

(1) 12.5010.00 (2) 12.5011.00